

IT2-MAS-QTG

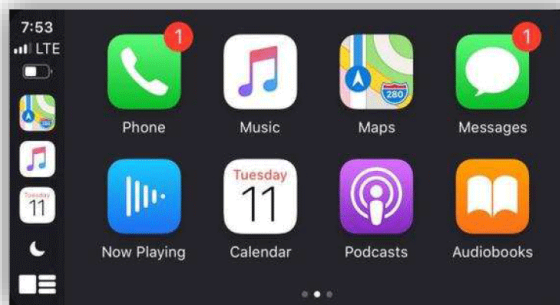

ZZPLAY

*CarPlay/Android Auto integration system for '14-'16
Maserati Quattroporte & Ghibli vehicles*

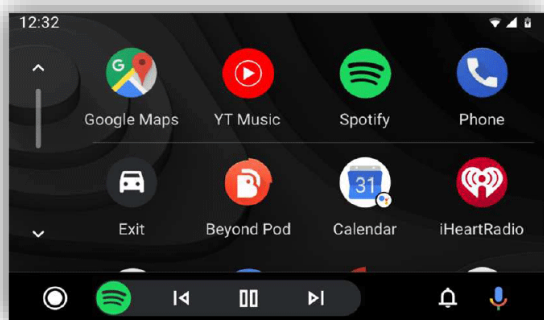

1080 Holland Drive, Boca Raton, FL 33487 | 929-220-1212

IT2-MAS-QTG Overview



Thank you for purchasing a genuine ZZ-2 CarPlay/Android Auto interface – the highest quality smartphone integration system on the market! We guarantee your satisfaction with this OE integration provided it is installed & used properly. Each kit has been specifically designed to work in the most logical way possible using OE controls. Due to the large variety of vehicle entertainment systems, some limitations will apply.

KIT COMPONENTS

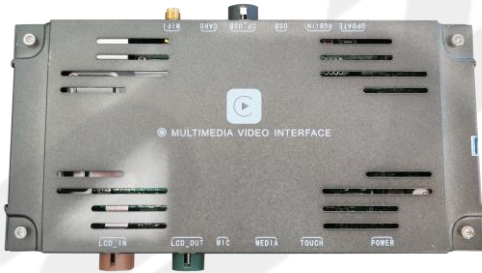

ZZPlay Interface (IT2)



Main T-Harness



Media Harness



USB INPUT Cable



3.5mm Audio Cable



BT/WIFI Antenna (SMB)



Microphone



USB Adapter (updates)



Dummy AUX plug



LCD Out Cable



LCD In Cable

DIP SWITCH SETTINGS

Dip Switch Settings – Reset power after changes (or press button fully once)

1	OFF/ON	OFF
2	OFF/ON	OFF/ON (PUT BACK TO OFF POSITION ONCE IT IS CALIBRATED)
3	OFF/ON	OFF
4	OFF/ON	guidelines/video (360)
5	OFF/ON	OFF
6	OFF/ON	OFF
7	OFF/ON	OFF
8	OFF/ON	aftermarket camera/OEM camera

IT2-MAS-QTG Installation Diagram



NOTES:

- You must be in AUX Audio source mode (OE Land Rover system) in order to hear audio playback from CarPlay/AA.
- The entire installation happens at the RADIO, not the screen.
- The provided 'Dummy AUX plug' must be connected to the OE AUX input port to allow for AUX in sound.

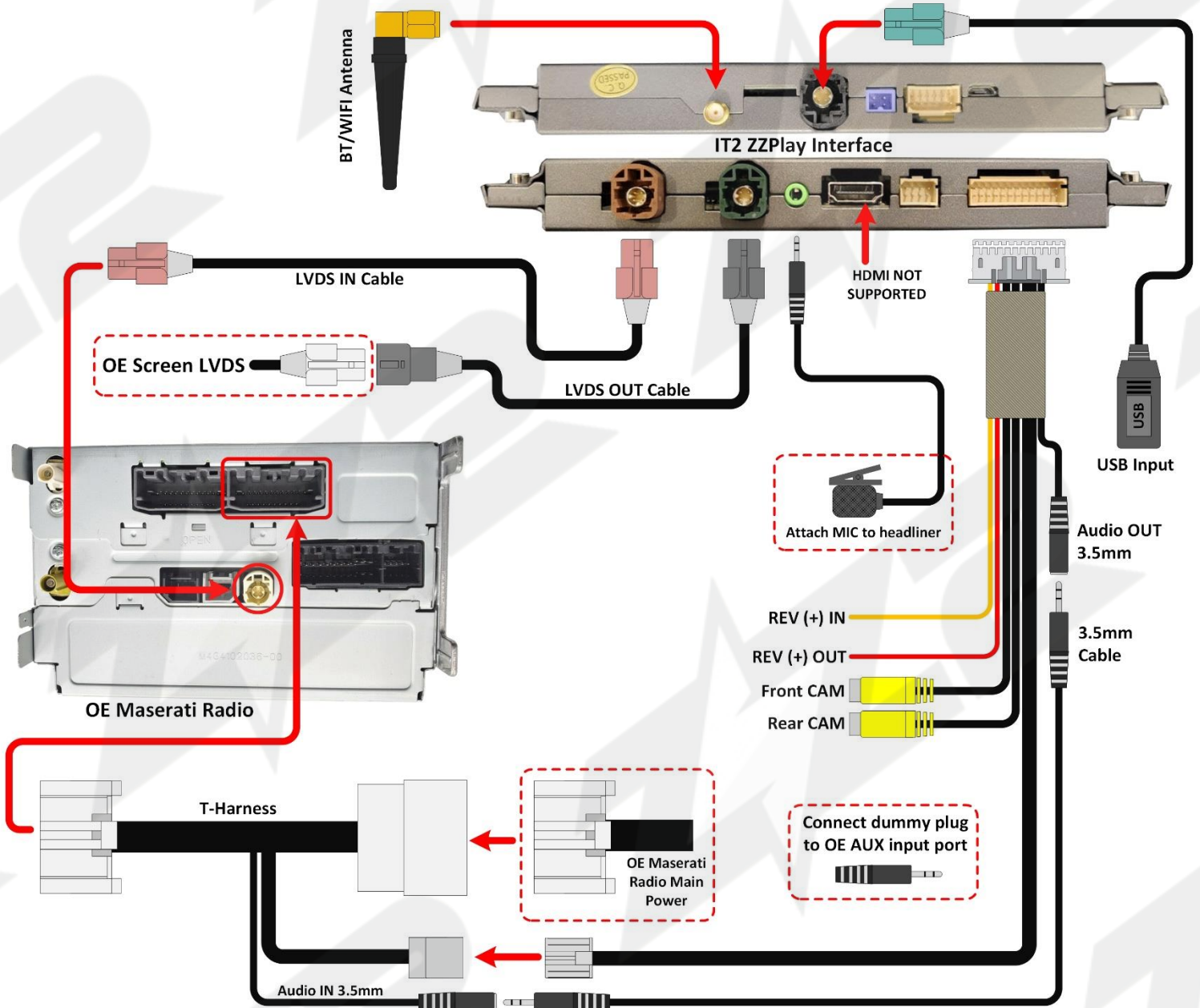

IT2 iPhone Pairing



For this system, it's best to try connecting to the Phone *via the interface first*, and if its having trouble connecting, find the interface through the phone (via Bluetooth) during this operation.

1. Begin by turning Bluetooth and WIFI ON on the iPhone first
(Settings > Bluetooth – set ON, then Settings > WIFI – set ON)
2. Next, with the interface menu screen on the radio screen (see further down document for information on switching to the interface), choose **Setup**.
3. Once in settings, swipe down to **Bluetooth**.
4. Once in 'Bluetooth', choose **Discover**.
5. Shortly after entering the 'Discover' menu, 'iPhone' should appear.
Select it, and it will ask to pair. Pair with the phone to begin the CarPlay registration process.
6. Follow the prompts on the phone to allow and use CarPlay. For a detailed step by step on this process, see the next page. Once the initial pairing is complete, CarPlay should load shortly. If not, go back to the main menu, and select 'CarPlay'.

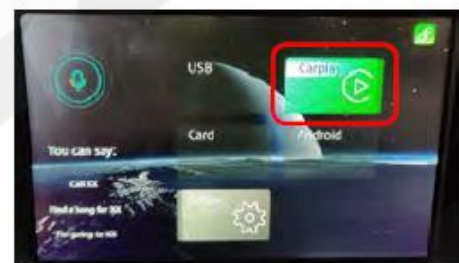

IT2 iPhone Pairing



1. When using a USB cable to connect your iPhone, *only use a certified Apple cable.*
2. To use wireless connectivity, follow these steps:
 - a. Go to Settings > Bluetooth and the phone should be able to find a Bluetooth device called 'IDCORE' or 'ZZ2' under 'Other Devices'.

3. A Bluetooth Pairing Request will be displayed on the screen with a specific code which should match what is shown on CarPlay. Select 'Pair'. Note: following the BT connection, there is no need to try and connect WIFI manually (although it does need to be ON), after the BT connection process is complete, the WIFI will connect automatically on its own.

4. Immediately following the Pairing notification, a new request to Sync your contact with the car will be displayed. Select 'Allow' in order to have caller ID and access to your contacts through CarPlay.

5. A notification asking for a permission to connect your iPhone to the car even when the phone is locked will pop up. Select 'Use CarPlay' and the CarPlay main screen should show up on the factory radio screen. If not, press and hold the radio switching button (*Arrow button*).

NOTE: If you're having pairing issues:

- Perform a 'hard reset' on the phone (will not delete data) in order to prevent any malfunction: With the phone unlocked, press & release VOL+, then press & release VOL-, then press and HOLD power for 10 seconds (wait for reboot – do not touch the screen).
- DELETE ALL other 'CarPlay' devices out of the phone (delete all in 'Settings – General – CarPlay')+
- Verify 'Low Data Mode' is not enabled in phone settings.
- Verify that the antenna is not mounted behind any metal dash panels.

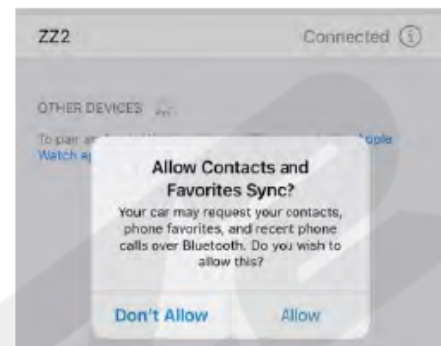
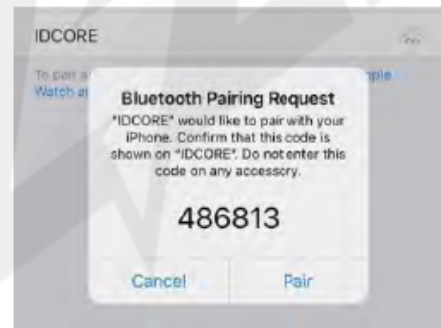

IT2 Android Pairing



For this system, it's best to try connecting to the Phone **via the interface first**, and if its having trouble connecting, find the interface through the phone (via Bluetooth) during this operation.

1. Begin by turning Bluetooth ON on the iPhone first (Settings > Bluetooth – set ON, then Settings > WIFI – set ON)
2. Next, with the interface menu screen on the radio screen (see further down document for information on switching to the interface), choose **Setup**.



3. Once in settings, swipe down to Bluetooth.

4. Once in 'Bluetooth', choose Discover.

5. Shortly after entering the 'Discover' menu, the Android phone name should appear. Select it, and it will ask to pair. Pair with the phone to begin the Android registration process.

6. Follow the prompts on the phone to allow and use Android Auto. For a detailed step by step on this process, see the next page. Once the initial pairing is complete, Android Auto should load shortly. If not, go back to the main menu, and select 'Android'.

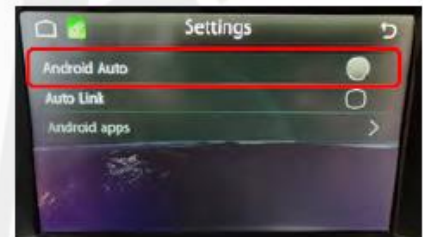
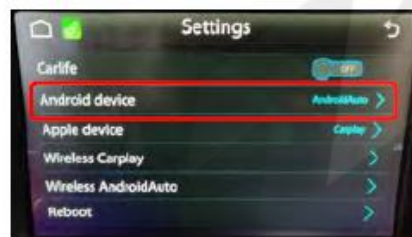

Inside **Setup**, swipe all the way down, press **Smart phone**

Choose **Android device**

Make sure **Android Auto** is selected. Go back to the main menu and you should be able to choose **Android Auto** now.

IT2 Android Pairing



1. When using a USB cable to connect your Android, only use a certified Android OE cable.
2. To use wireless connectivity (Android 11+ only), follow these steps:
 - a. Go to Settings > Bluetooth Device Connection, or LONG PRESS on the Bluetooth toggle to enter Bluetooth connections
 - b. Select 'Pair new device'
 - c. Choose 'IDCORE' or 'ZZ2'
 - d. Bluetooth Pairing Request will be displayed on the screen with a specific code. Select 'Pair'. Note: following the BT connection, there is no need to try and connect WIFI manually (although it does need to be ON), after the BT connection process is complete, the WIFI will connect automatically on its own.
 - e. Immediately following the Pairing notification, a system prompt may or may not appear for contacts sharing with the system. Allow all requests for the best user experience.
 - f. Shortly after allowing/denying pairing requests, Android Auto will appear on the main screen automatically (for most phones). If not, press & hold the switching button for 2 seconds to switch in and out of Android Auto (to OE radio mode): *Arrow button*.

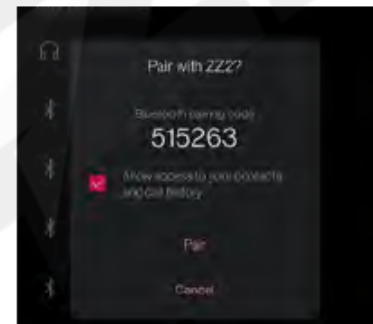

- Not every Android phone will work wirelessly. Pixel, Samsung & OnePlus devices equipped with Android 11 (or higher) have been tested to function well wirelessly. If your phone is having issues with wireless connectivity, verify with the installer that the antenna is not mounted behind any metal. If issues continue, use the original USB-C cable instead and connect to the interface's USB Input (do NOT use an aftermarket USB cable! – also, the vehicle's USB port is NOT used).
- Verify that 'Android Auto' is installed on your phone.
- Verify that in Android Auto settings (phone) that 'Wireless' is turned ON.
- Verify that WIFI is ON. The WIFI will connect automatically after Bluetooth has been properly paired.

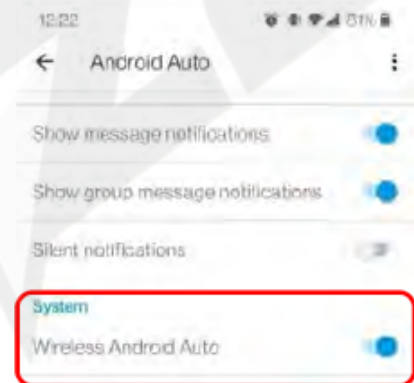

IT2 Interface Menu Overview



To gain access to the Interface menu, start in CarPlay/AA mode, and locate the exit tile, labeled as **'Maserati'** or **'Exit'**. Selecting this tile will bring you in the interface setup menu, NOT the Maserati OE system.

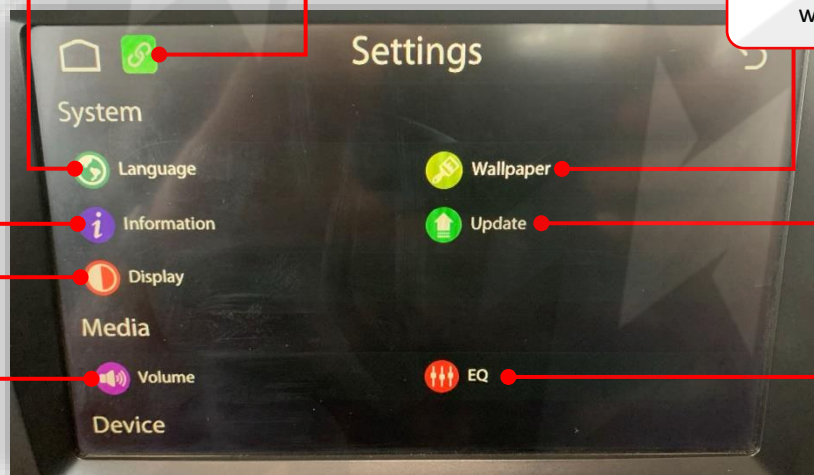

Change language here.

Indicates a Phone is currently linked.

Interface Version info.

Change (interface) wallpaper.

Display settings adjustments.

System updates require access to this menu.

Volume settings adjustments (alerts, Navigation, etc)

EQ setup adjustments (for AUX mode only)

NOT USED in North America

Bluetooth Connection Settings for initially pairing.

NOT USED in North America

Toggle Interface Bluetooth OFF/ON here

Activate FRONT CAM toggle – if a front camera was added, turn this setting ON to view the camera at any time by pressing and holding the CarPlay activation button (arrow) Note: 'FRONTVIEW' must be set OFF for this feature to work.

Turns on Front Camera view for showing front camera after leaving reverse gear for ~10 seconds. NOTE: DVR must be set to 'OFF' for this feature to work.

Adjust Rearview guideline settings or turn off rearview camera entirely

Smartphone settings (general) If using Android, 'Android Device' must be set to 'Android Auto' here.

Run this call quality test with all doors closed, engine running, no phone connected for improved MIC performance.

CODE: 1123. Adjusts the vehicle MAKE ICON button – This button exits CarPlay/AA and enters you into the interface menu (this menu)



Long press ◀ to switch to CarPlay, and press it again to go back to factory screen

CALL AUDIO ROUTING: If using the OEM system to handle phone calls, answer incoming calls with the steering wheel. **Also if using iPhone**, set 'Call Audio Routing' to 'Bluetooth Headset' (default is 'Automatic').

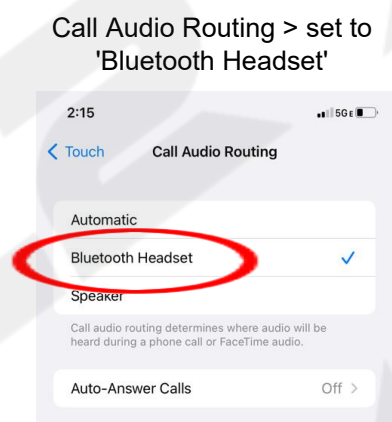
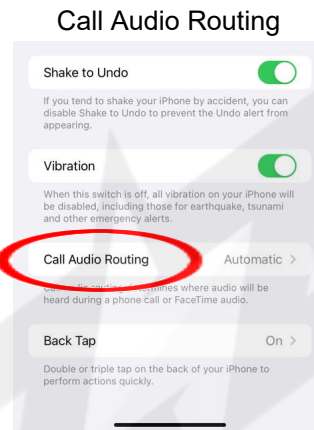
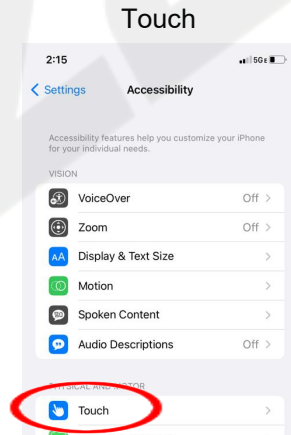
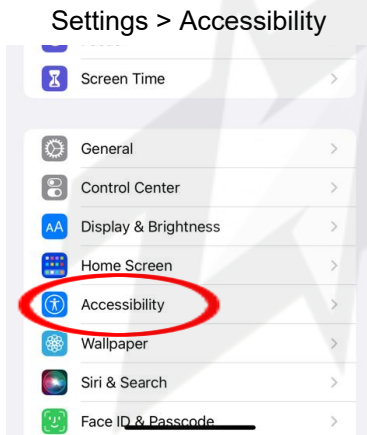



support@zz-2.com

929-220-1212

Toll free: 877-241-2526

Extension 2: Tech Support

Agreement: End user agrees to use this product in compliance with all State and Federal laws. ZZDOIS LLC dba ZZ-2 is not to be held liable for misuse of its product. If you do not agree, please discontinue use immediately and return product to retailer. This product is intended for off-road use and passenger entertainment only.